



jordan fishwick

51 Chamberlain Drive, SK9 2SN
Guide Price £189,950



Chamberlain Drive Wilmslow

Guide Price £189,950



NO CHAIN. A second floor (top floor) two double bedroom apartment located a short drive away from Wilmslow centre. Wilmslow offers a wide range of shopping facilities, bars, restaurants, leisure centre and Wilmslow station which allows easy direct access to London Euston and Manchester City centre. This apartment comprises: two spacious double bedrooms, a generous living room area with UPVC double glazed bay window to front aspect with access to the kitchen. The accommodation has a communal entrance area as well as a private entrance hallway leading into both double bedrooms and a modern three-piece white suite bathroom. Locally there is a wide choice of schools, state and private, alongside beautiful countryside areas surrounding. The property is gas central heated and uPVC double glazed. Internal viewings are a must to appreciate.



- Apartment
- Second Floor
- Living room/Dining Space
- Two Bedrooms
- Modern Bathroom
- Communal Gardens
- Good location
- Parking



Energy Efficiency Rating		
	Current	Potential
Very energy efficient - lower running costs		
(92 plus) A		
(81-91) B	80	80
(69-80) C		
(55-68) D		
(39-54) E		
(21-38) F		
(1-20) G		
Not energy efficient - higher running costs		
England & Wales	EU Directive 2002/91/EC	

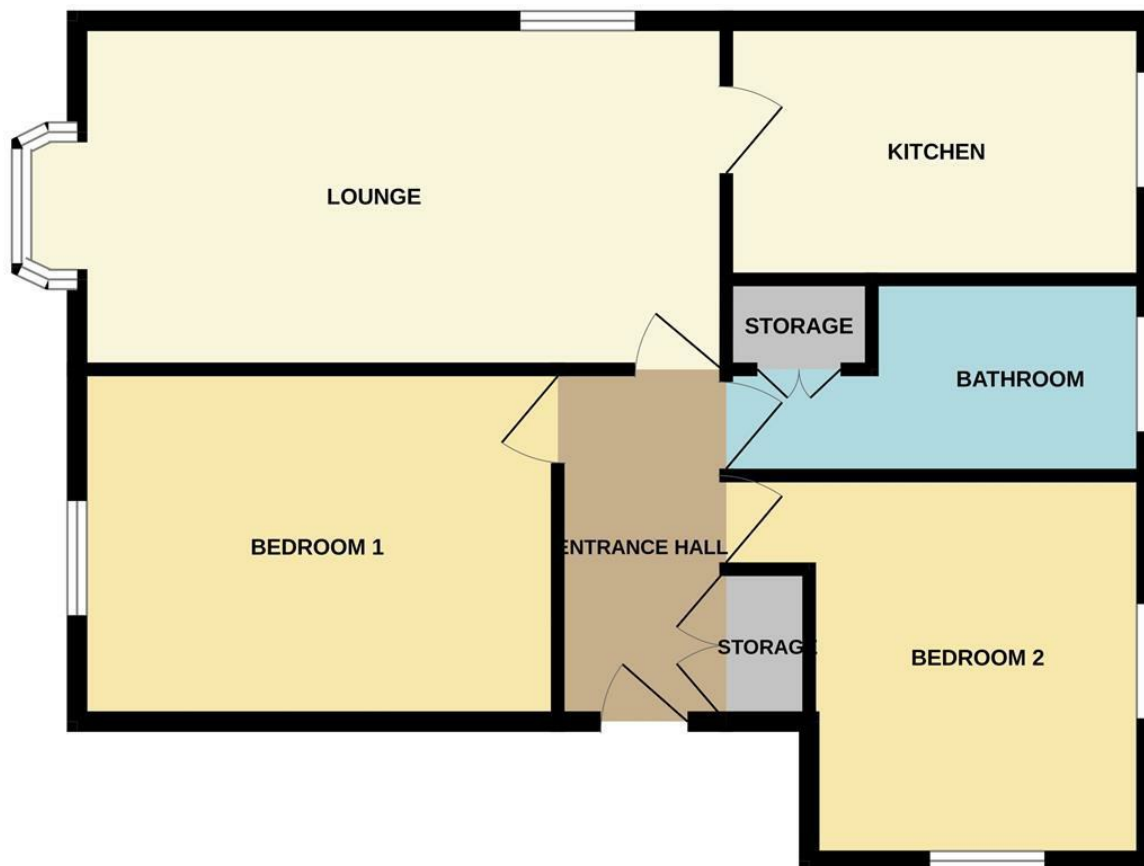

Measurements are approximate. Not to scale. Illustrative purposes only.
Made with Metropix ©2024



These particulars are believed to be accurate but they are not guaranteed and do not form a contract. Neither Jordan Fishwick nor the vendor or lessor accept any responsibility in respect of these particulars, which are not intended to be statements or representations of fact and any intending purchaser or lessee must satisfy himself by inspection or otherwise as to the correctness of each of the statements contained in these particulars. Any floorplans on this brochure are for illustrative purposes only and are not necessarily to scale.

Offices at: Chorlton, Didsbury, Disley, Hale, Glossop, Macclesfield, Manchester Deansgate, Manchester Whitworth Street, New Mills, Sale, Wilmslow and Withington

36-38 Alderley Road, Wilmslow, Cheshire, SK9 1JX

01625 532000

wilmslow@jordanfishwick.co.uk

www.jordanfishwick.co.uk